



Bringing together form and function





Accredited with the AIPC Gold Quality Standards and shortlisted for the APEX award for World's Best Convention Centre, the Palais des congrès de Montréal is the city's leading host site for major international meetings, while the city itself was ranked the top destination in the Americas for international association events by the Union of International Associations.

We offer versatile and functional facilities, equipped with the latest state-of-the-art technology, and accessible to persons with reduced mobility in a building whose contemporary architecture abounds with natural light. Everything is ready for you to capitalize on your space and a wide range of services.

The Palais' team of passionate professionals has a worldwide reputation for outstanding customer service. Each member is driven to deliver excellence, which explains why we achieve a customer satisfaction rate reaches 92%.

Since 1983, the Palais has hosted over 7,700 events and 20 million visitors. Our team of highly experienced and creative professionals is passionately devoted to maximizing the potential of our facilities, and hosting extraordinary events.

We offer you a centre with limitless possibilities.

### Our recognitions and certifications



Finalist for the APEX Award for World's Best Convention Centre



Accredited with AIPC Gold Quality Standards



Number one host city in the Americas for international events



Number one host city in the Americas for international conventions



2014 DSE Gold APEX Content Award Best Content - Event Venues



First prize at the DSA Awards in 2014, in the Best Government/Non-Profit Digital Signage category



Environmental Building Certification

# A centre with limitless possibilities

# LEVEL 1



Rental Space



Rental Space (Optional)



Common area



Restricted Area

- |  |                    |                   |            |                                  |  |                            |
|--|--------------------|-------------------|------------|----------------------------------|--|----------------------------|
| Main entrances   | Car entrances      | Parking           | ATM        | Security Operations Centre (SOC) | Charging stations – Electric cars                          | Pedestrian Network         |
| Entrances  | Shuttle terminals  | Freight elevators | Washrooms  | Cloakroom                        | Metro station – Accessible to people with reduced mobility | Bixi – Bike Sharing System |
| Entrances pedestrians and people with reduced mobility | Truck waiting area | Elevators         | Escalators | Phones                           |  |                            |

**Direct indoor access to hotels via RESO**

- Fairmont The Queen Elizabeth
- InterContinental
- Hotel Bonaventure Montréal
- DoubleTree by Hilton Montréal
- Marriott Château Champlain
- Le St-James
- Le Westin Montréal
- W Montréal
- Gouverneur Hotel Place Dupuis

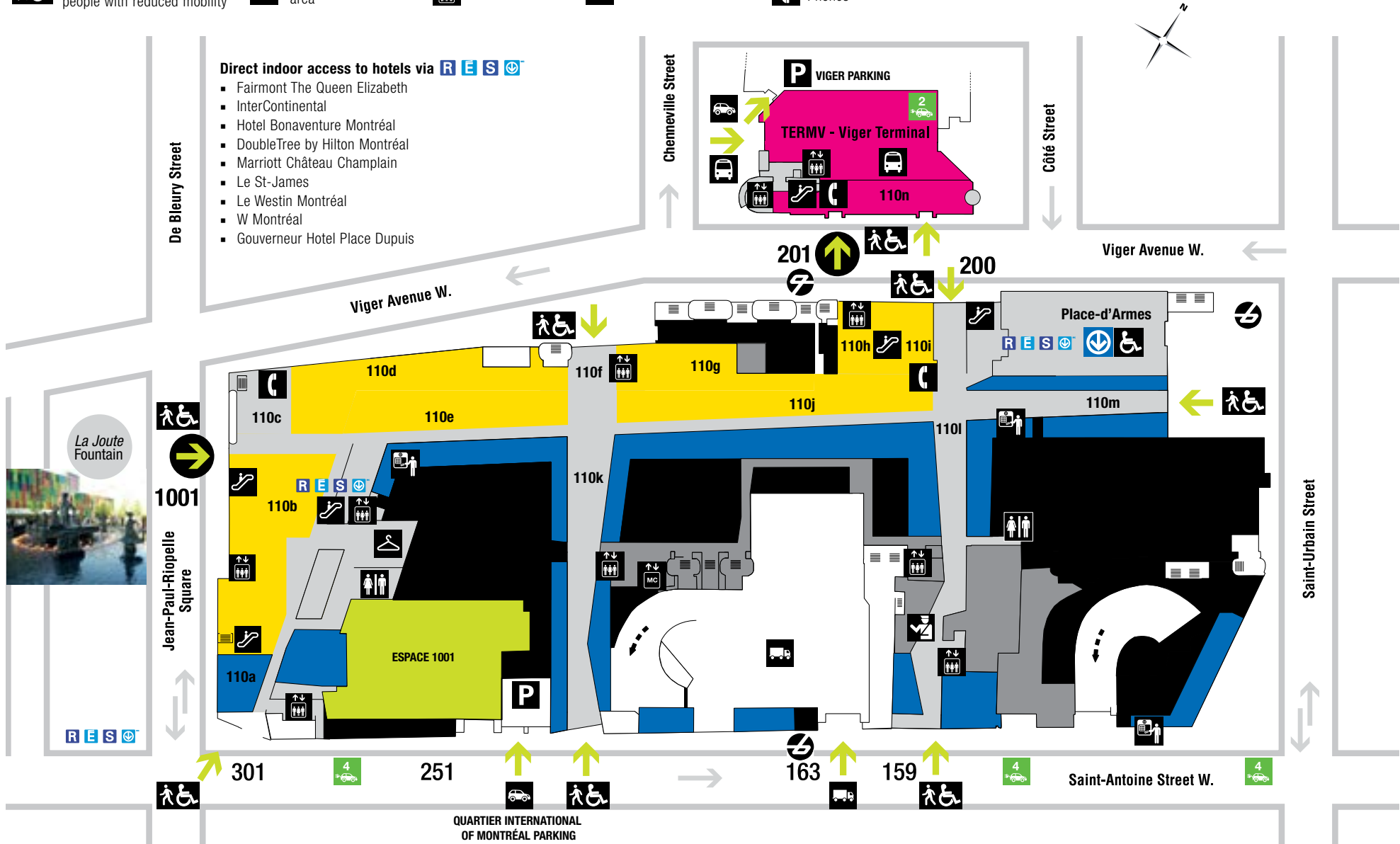

QUARTIER INTERNATIONAL OF MONTRÉAL PARKING

# Level 1

- Shopping Promenade
- Cloakroom for 1,800 items
- Direct indoor access to the subway and to a 32 km indoor pedestrian network connected to 4,000 hotel rooms
- Free Wi-Fi
- 28 digital display screens and a 90 sq. ft. video wall (8.5 m<sup>2</sup>)
- Shuttle terminals
- Truck waiting area
- Security Operations Centre (SOC)

SPACES		Reception (people)	Surface (square meters)	Surface (square feet)
110a	Place Riopelle South Hall	—	—	—
110b	Place Riopelle Hall	1,019	974	10,487
110c	Place Riopelle Hall North	—	—	—
110d	Lipstick Forest	753	700	7,531
110e	Palais Westside Passageway	727	675	7,271
110f	Jeanne-Mance Entrance	—	—	—
110g	Admission Area	568	528	5,678
110h	Westside Rest Area	165	153	1,648
110i	Eastside Rest Area	165	153	1,648
110j	Palais Central Passageway	547	508	5,468
110k	Jeanne-Mance Passageway	—	—	—
110l	Saint-François-Xavier Passageway	—	—	—
110m	Palais Eastside Passageway	—	—	—
110n	Viger Entrance	333	309	3,328
TERMV	Viger Terminal	875	813	8,746
<b>TOTAL</b>			<b>4,813</b>	<b>51,805</b>

Note: Maximum capacities are meant as guidelines only and may change without notice. They can vary according to the regulations in force, room configuration, type of event, cohabitation, audiovisual and/or food and beverage services required, as well as the total evacuation capacity by level.



# Level 2

- 247,537 sq. ft. (22,997 m<sup>2</sup>) on the same level
- 24 digital display screens
- Cloakroom for 2,200 items
- Storage space
- Official customs clearance onsite recognized by the Canada Border Services Agency
- Promoter offices
- Tourist information booth
- Indoor waiting area capable of accommodating 10 53-foot trailer trucks at the same time
- Freight elevators with capacities of 12,000 lbs (5,443 kg) and 18,000 lbs (8,165 kg)
- 15 unloading docks and 3 dock levelers

SPACES	Theater (people)	Banquet (10 people/table)	Classroom (3 people/table)	Reception (people)	Stand (10 x 10)	Width (meters)	Lenght (meters)	Height (meters)	Width (feet)	Lenght (feet)	Height (feet)	Surface (square meters)	Surface (square feet)
210abcdefgh	6,513	3,240	4,140	5,050	240	99.8	46.6	9.2	327' 3"	152' 9"	30'	4,666	50,228
210a	792	420	570	743	35	30.7	22.3	9.2	100' 10"	73'	30'	684	7,363
210b	448	250	288	435	21	17.9	22.3	9.2	58' 10"	73'	30'	399	4,296
210c	448	250	288	435	21	17.9	22.3	9.2	58' 10"	73'	30'	399	4,296
210d	825	420	570	821	38	33	22.3	9.2	108' 1"	73'	30'	734	7,897
210e	936	420	627	808	41	32.7	24.2	9.2	100' 10"	79' 6"	30'	791	8,514
210f	551	300	336	475	22	17.9	24.2	9.2	58' 10"	79' 6"	30'	434	4,674
210g	551	300	336	475	22	17.9	24.2	9.2	58' 10"	79' 6"	30'	434	4,674
210h	897	480	591	853	41	32.7	24.2	9.2	107' 2"	79' 6"	30'	791	8,514
210 Prefunction West	-	-	-	903	23	-	-	-	-	-	-	839	9,029
210 Prefunction North	-	-	-	434	7	-	-	-	-	-	-	403	4,335
220abcde	12,143	6,820	8,701	12,696	603	220.8	48 and 54	9.7	724' 5"	177' 1"	31' 9"	11,676	125,717
220a	1,800	1,120	1,420	1,726	82	33.8	48	9.7	110' 11"	157' 6"	31' 9"	1,587	17,088
220b	2,514	1,380	1,680	2,629	125	45	54	9.7	147' 7"	177' 1"	31' 9"	2,418	26,036
220c	2,622	1,440	1,857	2,776	132	47	54	9.7	154' 2"	177' 1"	31' 9"	2,553	27,480
220d	2,287	1,360	1,692	2,541	121	43	54	9.7	141' 1"	177' 1"	31' 9"	2,337	25,165
220e	2,920	1,520	2,052	3,024	144	52	54	9.7	170' 4"	177' 1"	31' 9"	2,781	29,948
220 Prefunction	-	-	-	1,421	30	-	-	-	-	-	-	1,321	14,212
230a	554	240	324	626	31	32	18	9.2	105'	59'	30'	597	6,426
230b	569	250	324	604	29	27.8	20	9.2	91' 1"	65' 7"	30'	553	5,961
210-220-230 X1 X2 X3 X4	-	13,860	-	13,863	954	-	-	9.2	-	-	30'	18,493	199,052
Viger Hall	-	-	-	902	40	-	-	-	-	-	-	838	9,016
<b>Extensions</b>													
X1	-	-	-	-	-	4.3	48	9.2	14' 1"	157' 6"	30'	206	2,219
X2	-	-	-	-	-	4.3	18	9	14' 1"	59'	29' 5"	77	838
X3	-	-	-	-	-	4.3 and 36.8	34.4 and 14.5	9	14' 1" and 120' 8"	112' 11" and 47' 6"	29' 5"	605	6,517
X4	-	-	-	-	-	4.6	20	9	15'	65' 7"	29' 5"	107	1,146
<b>Outdoors</b>													
Esplanade and Garden	-	-	-	-	-	-	-	-	-	-	-	1,992	21,440
Esplanade	-	-	-	904	-	-	-	-	-	-	-	840	9,041
Esplanade Terrace	-	-	-	84	-	-	-	-	-	-	-	78	836
<b>Total maximum capacity</b>	<b>13,863</b>	<b>13,860</b>	<b>13,863</b>	<b>13,863</b>	<b>1,054</b>							<b>22,810</b>	<b>245,521</b>

DOORS	Width (meters)	Height (meters)	Width (feet)	Height (feet)
A1	5.8	4.5	19'	14' 9"
A2	3	4.5	10'	14' 9"
B	3	4.5	10'	14' 9"
MC1	3	2.4	9' 8"	7' 10"
MC2	3.1	3.4	10' 2"	11' 1"
C	3	3	9' 10"	10'
D	5.8	4.5	19'	14' 9"
E	3	4.5	10'	14' 9"

PROMOTER OFFICES	Width (meters)	Lenght (meters)	Width (feet)	Lenght (feet)	Surface (square meters)	Surface (square feet)
20a	2.6	3.8	8' 6"	12' 5"	10	105
20b	2.5	3.1	8' 1"	10' 1"	8	82
22c	7.5	6	24' 10"	19' 6"	45	484
22d	8	7.5	26'	24' 10"	60	645
22e	6.5	10	21' 6"	32' 7"	65	700

Note: Maximum capacities are meant as guidelines only and may change without notice. They can vary according to the regulations in force, room configuration, type of event, cohabitation, audiovisual and/or food and beverage services required, as well as the total evacuation capacity by level.

# MEZZANINES 3 AND 4

Rental Space

-  Cloakroom
-  Escalators
-  Infirmary
-  Phones
-  Elevators
-  Freight elevators
-  Information
-  Washrooms

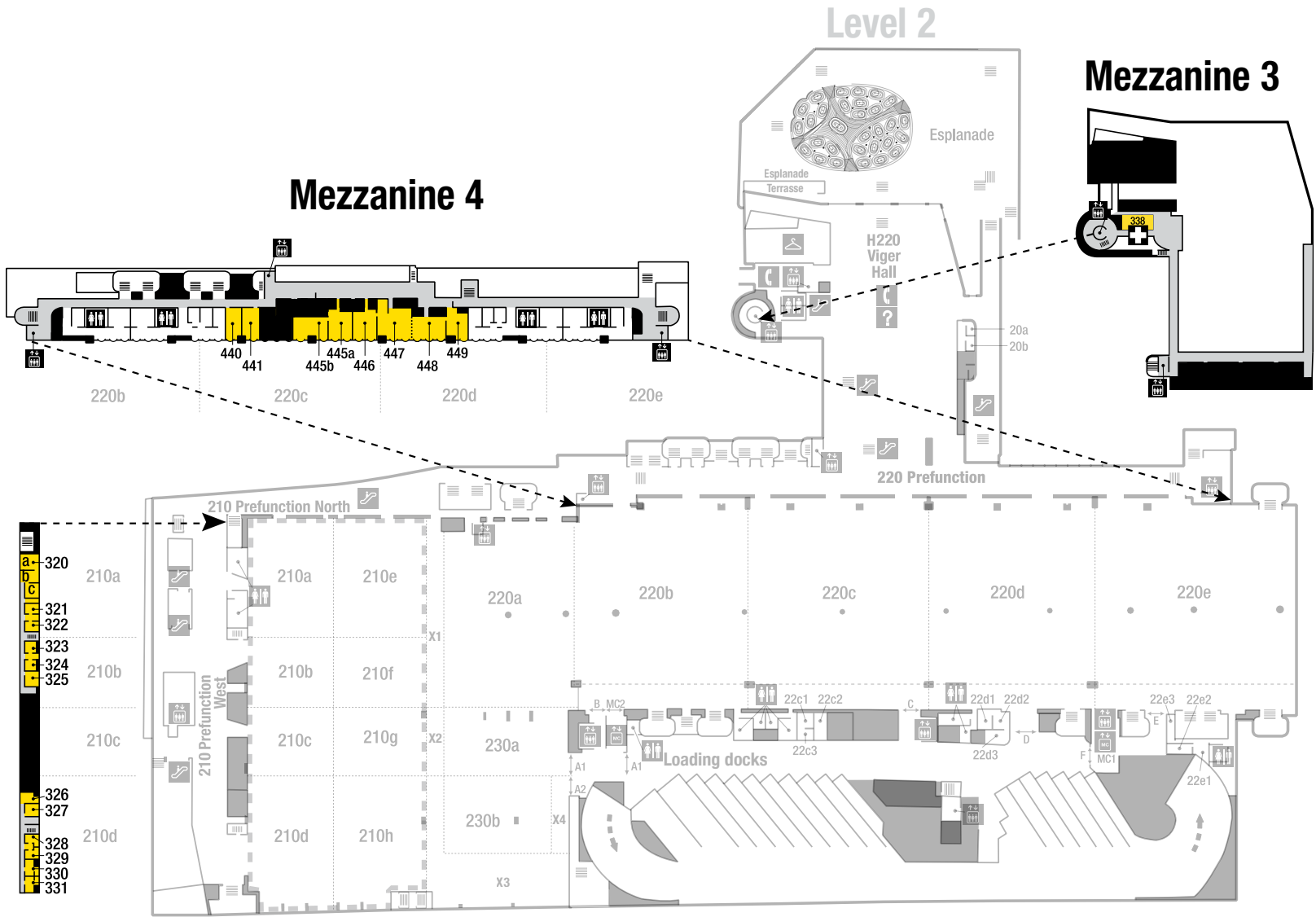



# Mezzanines 3 and 4

- Offices and lounges ideal for organizing committees
- Simultaneous translation booths
- Dressing rooms
- Infirmary

## Mezzanine 3

SPACES	Width (meters)	Lenght (meters)	Height (meters)	Width (feet)	Lenght (feet)	Height (feet)	Surface (square meters)	Surface (square feet)
<b>Dressing Rooms</b>								
330	3.5	2.4	2.4	11' 7"	7' 11"	7' 9"	9	91
331	3.7	2.4	2.3	12'	7' 11"	7' 5"	9	95
<b>Simultaneous Translation Rooms</b>								
321	2.8	3.5	2.4	9' 3"	11' 4"	7' 11"	10	105
322	2.7	3.5	2.4	9'	11' 5"	7' 10"	10	103
323	2.9	3.5	2.4	9' 6"	11' 5"	7' 9"	10	108
324	2.8	3.5	2.4	9' 3"	11' 5"	7' 9"	10	106
328	2.3	3.5	2.4	7' 6"	11' 4"	7' 11"	9	95
329	2.3	3.5	2.4	7' 5"	11' 4"	7' 10"	9	95
<b>Offices</b>								
320abc	–	–	–	–	–	–	48	520
320a	4.1	4.8	2.4	15' 9"	13' 5"	7' 11"	20	211
320b	4.8	3.2	2.4	15' 9"	10' 6"	7' 11"	15	165
320c	3.5	3.9	2.4	11' 5"	12' 8"	7' 10"	14	144
325	3.2	3.5	2.4	10' 4"	11' 5"	7' 10"	11	118
326	2.5	4.8	2.4	8'	15' 9"	7' 10"	10	111
327	3.6	3.5	2.4	11' 11"	11' 4"	7' 10"	13	135
<b>Infirmary</b>								
338	–	–	–	–	–	–	25	264

## Mezzanine 4

SPACES	Conference (people)	Reception (people)	Width (meters)	Lenght (meters)	Height (meters)	Width (feet)	Lenght (feet)	Height (feet)	Surface (square meters)	Surface (square feet)
<b>Boardrooms</b>										
440	16	–	4.2	7.8	2.4	13' 10"	25' 5"	8'	33	351
441	16	–	4.3	7.8	2.4	14' 2"	25' 5"	8'	34	360
445b	16	–	5.1	9.2	2.7	16' 8"	30' 2"	9'	46	489
447	16	–	7.7	8.8	2.7	25' 1"	28' 10"	8' 9"	70	749
448	16	–	4.8	8.9	2.7	15' 8"	29' 2"	8' 9"	42	455
<b>Lounges</b>										
445a	–	45	6.1	6.7	2.7	20'	22' 7"	9'	46	492
446	–	45	6.1	6.7	2.7	20'	22' 7"	9'	46	492
449	–	35	5.7	6.1	2.4	18' 7"	19' 10"	8' 9"	35	378

Note: Maximum capacities are meant as guidelines only and may change without notice. They can vary according to the regulations in force, room configuration, type of event, cohabitation, audiovisual and/or food and beverage services required, as well as the total evacuation capacity by level.

# LEVEL 5

Rental Space

Rental Space (Optional)

Ballroom

Kitchen

Official Audiovisual Supplier



Elevators  
 Escalators

Freight elevators  
 Phones

Washrooms

## Mezzanine 6



### Rooms 510 to 518



URBAN AGRICULTURE LAB

# Level 5

- 45,334 sq. ft. (4,211 m<sup>2</sup>) ballroom
- 16 rooms on the same level can be subdivided into up to 63 individual meeting rooms and venues
- Montréal's largest institutional kitchen
- 20 digital display screens
- Wide corridors and large open areas to facilitate the flow of attendees

## Rooms 510 to 518

SPACES	Theater (people)	Banquet (10 people /table)	Classroom (3 people /table)	Hollow square (3 people /table)	Conference (3 people /table)	U-shape (3 people /table)	Reception (people)	Stand (10 x 10)	Width (meters)	Length (meters)	Height (meters)	Width (feet)	Length (feet)	Height (feet)	Surface (square meters)	Surface (square feet)
510abcd	748	360	402	—	—	—	610	30	33.4	16.8	4.8	109' 7"	55' 1"	15' 10"	561	6,040
510a	189	80	75	60	48	48	155	8	17	8.4	4.8	55' 9"	27' 6"	15' 10"	143	1,537
510b	175	80	72	54	48	51	150	7	16.4	8.4	4.8	53' 10"	27' 6"	15' 10"	138	1,483
510c	189	80	96	60	48	48	155	8	17	8.4	4.9	55' 9"	27' 6"	15' 11"	143	1,537
510d	182	80	90	54	48	51	150	7	16.4	8.4	4.8	53' 10"	27' 6"	15' 10"	138	1,483
510-511 Foyer	—	—	—	—	—	—	554	17	—	—	—	—	—	—	515	5,543
511abcdef	1,112	660	660	—	—	—	907	42	37.9	22	4.8	124' 4"	72' 2"	15' 10"	834	8,976
511a	160	90	78	48	36	39	150	7	12.5	11	4.9	41'	36'	15' 11"	138	1,480
511b	160	90	78	48	36	39	152	8	12.7	11	4.8	41' 8"	36'	15' 10"	140	1,504
511c	170	90	78	48	36	39	152	8	12.7	11	4.9	41' 8"	36'	15' 11"	140	1,504
511d	160	90	78	48	36	39	150	7	12.5	11	4.9	41'	36'	15' 11"	138	1,480
511e	160	90	78	48	36	39	152	8	12.7	11	4.8	41' 8"	36'	15' 10"	140	1,504
511f	170	90	78	48	36	39	152	8	12.7	11	4.9	41' 8"	36'	15' 11"	140	1,504
512abcdefgh	750	460	414	—	—	—	612	30	42	13.4	4.8	137' 10"	44'	15' 8"	563	6,056
512a	78	50	39	30	30	30	76	4	10.5	6.7	4.8	34' 4"	22'	15' 9"	70	757
512b	78	50	39	30	30	30	76	4	10.5	6.7	4.8	34' 4"	22'	15' 9"	70	757
512c	78	50	39	30	30	30	76	4	10.5	6.7	4.8	34' 4"	22'	15' 8"	70	757
512d	78	50	42	30	30	30	76	4	10.5	6.7	4.8	34' 4"	22'	15' 8"	70	757
512e	78	50	39	30	30	30	76	4	10.5	6.7	4.8	34' 4"	22'	15' 9"	70	757
512f	78	50	39	30	30	30	76	4	10.5	6.7	4.8	34' 4"	22'	15' 9"	70	757
512g	78	50	39	30	30	30	76	4	10.5	6.7	4.8	34' 4"	22'	15' 8"	70	757
512h	78	50	42	30	30	30	76	4	10.5	6.7	4.8	34' 4"	22'	15' 8"	70	757
513abcdef	722	360	390	—	—	—	588	29	44	12.3	4.5	144' 5"	40' 4"	14' 10"	541	5,826
513a	101	60	54	36	36	36	92	5	6.9	12.3	4.6	22' 7"	40' 4"	15'	85	914
513b	121	60	54	42	36	39	107	5	8	12.3	4.6	26' 2"	40' 4"	14' 11"	98	1,059
513c	112	60	54	36	36	36	100	5	7.5	12.3	4.6	24' 7"	40' 4"	15'	92	993
513d	112	60	54	36	36	36	100	5	7.5	12.3	4.5	24' 7"	40' 4"	14' 10"	92	993
513e	112	60	54	36	36	36	102	5	7.6	12.3	4.5	24' 11"	40' 4"	14' 10"	93	1,006
513f	92	60	36	36	36	36	87	4	6.5	12.3	4.6	21' 4"	40' 4"	14' 11"	80	861
514abc	320	180	144	—	—	—	261	13	22.2	10.8	4.7	72' 10"	35' 5"	15' 6"	240	2,592
514a	86	60	45	36	30	36	87	4	7.4	10.8	4.8	24' 4"	35' 5"	15' 7"	80	864
514b	86	60	45	36	30	36	87	4	7.4	10.8	4.7	24' 4"	35' 5"	15' 6"	80	864
514c	86	60	45	36	30	36	87	4	7.4	10.8	4.8	24' 4"	35' 5"	15' 7"	80	864
515abc	308	180	144	—	—	—	251	12	21.4	10.8	4.6	70' 2"	35' 5"	15'	231	2,488
515a	89	60	42	36	30	30	86	4	7.3	10.8	4.6	24'	35' 5"	15'	79	849
515b	89	60	42	36	30	30	88	4	7.5	10.8	4.6	24' 7"	35' 5"	15'	81	872
515c	78	50	40	30	30	30	78	4	6.6	10.8	4.6	21' 7"	35' 5"	15'	71	767
516abcde	1,042	600	588	—	—	—	850	41	42.7	18.3	4.5	140' 1"	60'	14' 10"	781	8,412
516a	168	90	87	54	54	54	137	7	6.9	18.3	4.5	22' 7"	60'	14' 10"	126	1,359
516b	195	100	81	60	54	54	159	8	8	18.3	4.5	26' 2"	60'	14' 10"	146	1,576
516c	361	200	198	—	—	—	295	15	14.8	18.3	4.6	48' 6"	60'	14' 11"	271	2,916
516d	183	100	81	60	54	54	149	7	7.5	18.3	4.5	24' 7"	60'	14' 10"	137	1,477
516e	124	50	57	54	54	51	109	5	5.5	18.3	4.5	18'	60'	14' 10"	101	1,084
517abcd	5,615	2,990	3,180	—	—	—	4,579	218	89.6	47	7.4	294'	154'	24' 3"	4,211	45,334
517a	1,434	840	936	—	—	—	1,370	65	26.8	47	7.4	88'	154'	24' 4"	1,260	13,560
517b	1,128	520	624	—	—	—	920	44	18	47	7.5	59'	154'	24' 5"	846	9,107
517c	1,128	520	624	—	—	—	920	44	18	47	7.5	59'	154'	24' 5"	846	9,107
517d	1,570	840	936	—	—	—	1,370	65	26.8	47	7.4	88'	154'	24' 3"	1,260	13,560
517 Foyer	—	—	—	—	—	—	1,684	29	—	—	—	—	—	—	1,587	17,089
518abc	444	240	210	—	—	—	362	18	22.2	15	4.7	72' 10"	49' 2"	15' 4"	333	3,585
518a	144	70	63	48	42	42	121	6	7.4	15	4.7	24' 4"	49' 2"	15' 4"	111	1,195
518b	146	70	63	48	42	42	122	6	7.5	15	4.7	24' 7"	49' 2"	15' 4"	113	1,211
518c	145	70	63	48	42	42	119	6	7.3	15	4.7	24'	49' 2"	15' 4"	110	1,179

Note: Maximum capacities are meant as guidelines only and may change without notice. They can vary according to the regulations in force, room configuration, type of event, cohabitation, audiovisual and/or food and beverage services required, as well as the total evacuation capacity by level.

# LEVEL 5 AND MEZZANINE 6

 Rental Space

 Rental Space (Optional)



 Ballroom

 Kitchen

 Official Audiovisual Supplier

 Urban Agriculture Lab of the Palais des congrès de Montréal

 Elevators  
 Escalators

 Freight elevators  
 Phones

 Washrooms

## Mezzanine 6

### Rooms 519 to 525

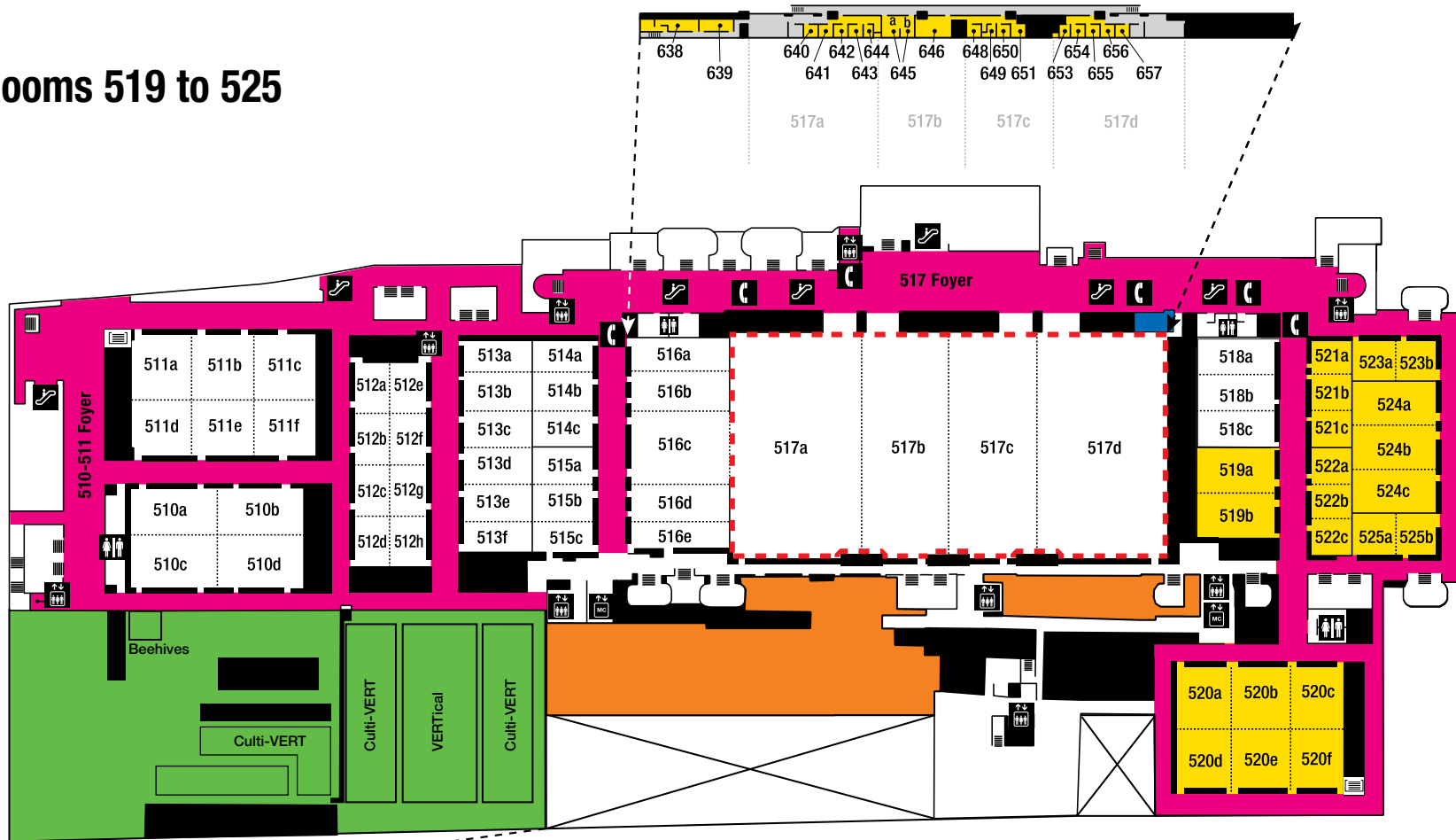

URBAN AGRICULTURE LAB

# Level 5 and Mezzanine 6

- Dressing rooms
- Simultaneous translation rooms
- Offices

## Rooms 519 to 525

SPACES	Theater (people)	Banquet (10 people /table)	Classroom (3 people /table)	Hollow square (3 people /table)	Conference (3 people /table)	U-shape (3 people /table)	Reception (people)	Stand (10 x 10)	Width (meters)	Length (meters)	Height (meters)	Width (feet)	Length (feet)	Height (feet)	Surface (square meters)	Surface (square feet)
519ab	370	200	201	—	—	—	302	15	18.5	15	4.7	60' 8"	49' 2"	15' 5"	279	3,004
519a	180	80	90	48	42	48	152	8	9.3	15	4.7	30' 6"	49' 2"	15' 5"	140	1,502
519b	180	80	90	48	42	48	152	8	9.3	15	4.7	30' 6"	49' 2"	15' 5"	140	1,502
520abcdef	1,111	600	600	—	—	—	906	42	34.3	24.3	4.9	112' 6"	79' 8"	16'	835	8,988
520a	162	90	87	54	30	42	151	7	11.5	12.1	4.9	37' 8"	39' 8"	16'	139	1,498
520b	162	90	87	54	30	42	151	7	11.5	12.1	4.9	37' 8"	39' 8"	16'	139	1,498
520c	162	90	87	54	30	42	151	7	11.5	12.1	4.9	37' 8"	39' 8"	16'	139	1,498
520d	162	90	87	54	30	42	151	7	11.5	12.1	4.9	37' 8"	39' 8"	16'	139	1,498
520e	162	90	87	54	30	42	151	7	11.5	12.1	4.9	37' 8"	39' 8"	16'	139	1,498
520f	162	90	87	54	30	42	151	7	11.5	12.1	4.9	37' 8"	39' 8"	16'	139	1,498
521abc	217	120	102	—	—	—	177	9	22.3	7.3	4.8	73' 1"	24'	15' 7"	163	1,754
521a	56	40	27	24	18	24	59	3	7.4	7.3	4.8	24' 3"	24'	15' 7"	54	582
521b	56	40	27	24	18	24	60	3	7.5	7.3	4.8	24' 7"	24'	15' 7"	55	590
521c	54	40	21	24	18	24	59	3	7.4	7.3	4.8	24' 3"	24'	15' 7"	54	582
522abc	209	120	99	—	—	—	171	8	21.5	7.3	4.8	70' 6"	24'	15' 7"	157	1,690
522a	66	40	27	24	18	24	59	3	7.4	7.3	4.8	24' 4"	24'	15' 7"	54	582
522b	66	40	27	24	18	24	60	3	7.5	7.3	4.8	24' 7"	24'	15' 8"	55	589
522c	58	20	27	24	18	21	52	3	6.6	7.3	4.8	21' 7"	24'	15' 8"	48	519
523ab	168	80	84	54	48	48	140	7	17.7	7.3	4.8	58'	24'	15' 10"	129	1,393
523a	78	40	39	30	24	21	70	3	8.8	7.3	4.8	28' 11"	24'	15' 10"	64	693
523b	78	40	33	30	24	21	70	4	8.9	7.3	4.9	29' 2"	24'	15' 11"	65	700
524abc	547	280	303	—	—	—	446	22	26.8	15.3	4.6	87' 11"	50' 2"	14' 11"	410	4,414
524a	166	80	87	54	42	51	148	7	8.9	15.3	4.6	29' 2"	50' 2"	15'	136	1,466
524b	160	80	84	54	42	51	151	7	9.1	15.3	4.6	29' 10"	50' 2"	15' 1"	139	1,499
524c	166	80	84	54	42	51	146	7	8.8	15.3	4.6	28' 11"	50' 2"	14' 11"	135	1,449
525ab	182	100	84	60	48	54	148	7	17.7	7.7	4.8	58'	25' 3"	15' 7"	136	1,467
525a	79	40	33	30	24	27	74	4	8.8	7.7	4.8	28' 11"	25' 3"	15' 8"	68	729
525b	84	40	33	30	24	27	75	4	8.9	7.7	4.8	29' 2"	25' 3"	15' 7"	69	738
<b>Total maximal capacity</b>	<b>10,000</b>	<b>7,530</b>	<b>7,605</b>				<b>10,000</b>	<b>590</b>							<b>12,510</b>	<b>134,651</b>

## Mezzanine 6

SPACES	Width (meters)	Length (meters)	Height (meters)	Width (feet)	Length (feet)	Height (feet)	Surface (square meters)	Surface (square feet)
<b>Dressing Rooms</b>								
638	2.6	8.6	2.1	8' 5"	28' 5"	6' 11"	19	208
639	2.6	7	2.1	8' 5"	22' 11"	6' 11"	18	193
<b>Simultaneous Translation Rooms</b>								
640	2.6	2.7	2.1	8' 6"	9'	6' 11"	7	77
641	2.5	2.7	2.1	8' 2"	8' 11"	6' 11"	7	73
642	2.7	2.7	2.1	8' 9"	8' 10"	7'	7	77
643	2.7	2.8	2.1	8' 9"	9' 1"	7'	7	79
644	2	2.9	2.1	6' 8"	9' 6"	7'	6	63
648	2.7	2.7	2	8' 8"	8' 9"	6' 7"	7	76
649	1.1	2.5	2.1	3' 8"	8'	6' 10"	3	29
650	2.4	2.7	2.1	8' 10"	7' 9"	6' 10"	6	68
651	1.7	2.3	2.1	5' 6"	7'	6' 11"	4	39
653	2	2.9	2.1	6' 6"	9' 6"	7'	6	62
654	2.7	2.8	2.1	8' 10"	9' 1"	7'	8	80
655	2.7	2.7	2.1	8' 9"	8' 10"	7'	7	77
656	2.7	2.5	2.1	8' 2"	8' 10"	6' 11"	7	72
657	2.4	2.9	2	8'	9' 5"	6' 5"	7	75
<b>Offices</b>								
645ab	—	—	—	—	—	—	18	198
645a	2.9	3.6	2.2	9' 7"	11' 10"	7' 1"	11	113
645b	2.7	2.9	2.2	8' 11"	9' 7"	7' 1"	8	85
646	4.3	7.4	2.2	14' 1"	24' 3"	7' 1"	25	271

Note: Maximum capacities are meant as guidelines only and may change without notice. They can vary according to the regulations in force, room configuration, type of event, cohabitation, audiovisual and/or food and beverage services required, as well as the total evacuation capacity by level.

# LEVEL 7 AND MEZZANINE 8

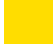
 Rental Space

 Rental Space (Optional)

 Ballroom

 Marquee in season

 Kitchen

 Elevators

 Freight elevator

 Escalators

 Washrooms

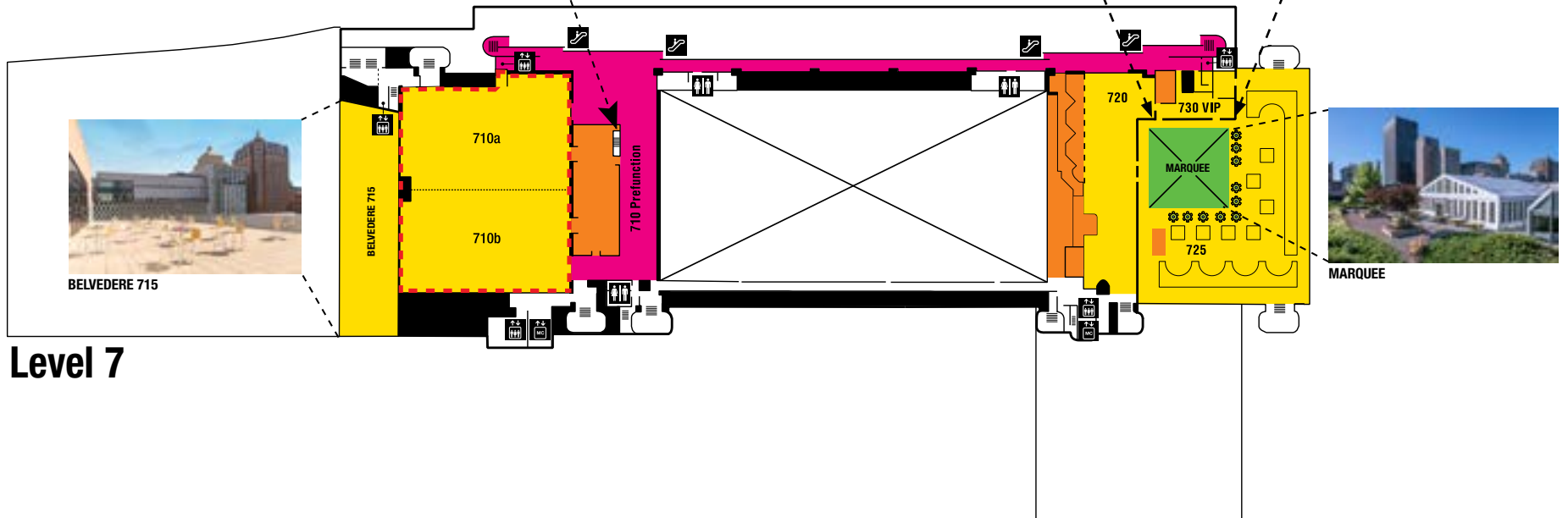
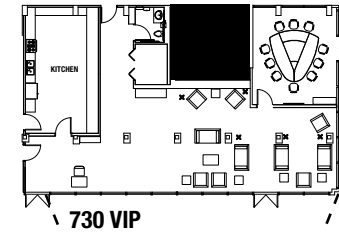
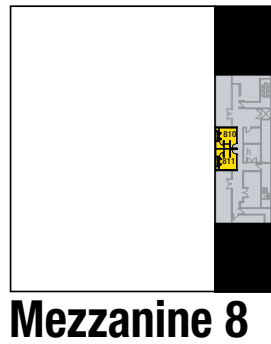

# Level 7 and Mezzanine 8

- 19,975 sq. ft. (1,856 m<sup>2</sup>) ballroom
- 11,727 sq. ft. (1,089 m<sup>2</sup>) terrace, partly covered in season with a 3,600 sq. ft. (334 m<sup>2</sup>) marquee
- Belvedere overlooking downtown Montréal
- Large atrium for hosting a 630-person reception with access to the terrace
- VIP Lounge
- Dressing rooms
- 4 digital display screens

## Level 7

SPACES	Theater (people)	Banquet (10 people/table)	Classroom (3 people/table)	Reception (people)	Stand (10 x 10)	Width (meters)	Length (meters)	Height (meters)	Width (feet)	Length (feet)	Height (feet)	Surface (square meters)	Surface (square feet)
710 Prefunction	–	–	–	652	21	–	–	–	–	–	–	605	6,515
710ab	1,909	1,210	1,308	1,909	98	47	39.2	6.7	154' 6"	128' 7"	22' 1"	1,856	19,975
710a	1,220	600	660	1,220	52	24	39.2	6.7	77' 1"	128' 7"	22' 1"	957	10,300
710b	960	600	660	960	48	24	39.2	6.7	77' 1"	128' 7"	22' 1"	899	9,675
720 Atrium	–	350	–	630	–	–	–	–	–	–	–	558	6,328
730 VIP*	–	–	–	50	–	–	–	–	–	–	–	142	1,528
<b>Outdoors</b>													
715 Belvedere	–	–	–	751	–	45	13.3	–	43' 9"	148' 10"	–	621	6,688
Terrace and Garden	–	–	–	–	–	–	–	–	–	–	–	1,818	19,575
725 Terrace	–	250	–	630	–	18.3	18.3	6.4	60'	60'	21'	1,089	11,727
Marquee	–	250	–	360	–	–	–	–	–	–	–	334	3,600
Excluding Marquee Area	–	–	–	270	–	–	–	–	–	–	–	755	8,127
<b>Total maximum capacity</b>	<b>1,909</b>	<b>1,909</b>	<b>1,909</b>	<b>1,909</b>	<b>122</b>							<b>4,902</b>	<b>52,761</b>

\* The Ambassadors Lounge (730 VIP) houses a private kitchen, bathroom and cloakroom, couches with coffee tables, as well as a boardroom featuring a 52-inch plasma screen, an integrated projection system and a teleconferencing system.

## Mezzanine 8

SPACES	Width (meters)	Length (meters)	Height (meters)	Width (feet)	Length (feet)	Height (feet)	Surface (square meters)	Surface (square feet)
<b>Dressing Rooms</b>								
810	2.5	3.3	2.4	8' 4"	10' 8"	7' 8"	8	89
811	2.5	3.3	2.3	8' 3"	10' 9"	7' 8"	8	89

Note: Maximum capacities are meant as guidelines only and may change without notice. They can vary according to the regulations in force, room configuration, type of event, cohabitation, audiovisual and/or food and beverage services required, as well as the total evacuation capacity by level.



**Urban Agriculture Lab of the**  
Palais des congrès de Montréal

## Fighting Urban Heat Effect Islands

The Palais des congrès is the main showcase for experimentation and promotion of the technologies and techniques in urban farming in Québec.

Spanning 20,100 sq. ft. (1,867 m<sup>2</sup>), the project includes:

- Culti-VERT: Experimentation of green rooftops and container gardening
- Hives with a total capacity of up to 50,000 honeybees, contributing to biodiversity and pollination
- VERTical project: Urban farming project using vertical structure with scaffolds and tarps
- Urban vines: Canada's first urban rooftop vineyard and world's first in northern environment

In addition to fighting urban heat effect islands, the Lab produces honey and between 650 kg and a ton of fruits, vegetables and fine herbs each summer, fresh ingredients to be used in the dishes prepared for meeting delegates by Capital Catering. Surplus food is also donated to La Maison du Père homeless shelter.

The Palais was presented with the prestigious AIPC Innovation Award for its Urban Agriculture Lab and its innovations in sustainable development.



Urban Agriculture Lab - Level 5, area of 20,100 sq. ft. (1,867 m<sup>2</sup>)



Level 7, area of 11,727 sq. ft. (1,089 m<sup>2</sup>)

## SUSTAINABLE DEVELOPMENT

### Strongly committed

Our sustainability program entrenches the Palais des congrès de Montréal as a leader in the city's tourism industry and as the premier venue for green events.

After becoming one of the first convention centres in Canada to earn the BOMA BEST environmental certification, the Palais also went on to surpass its energy saving objectives. The Palais uses the latest innovations to continually improve its environmental performance, a practice it started ever since it hosted the seminal United Nations Framework Convention on Climate Change in 2005.





## A kitchen staff that loves to cook

The experienced staff, some of whom have been with Capital Catering for more than 20 years, love to work in Montréal's largest institutional kitchen. Their unparalleled know-how ensures every customer from anywhere in the world will enjoy the level of cuisine Montréal is reputed for.

## Served to perfection

Capital Catering is the exclusive caterer of the Palais des congrès de Montréal. The team always looks forward to serving up an unforgettable culinary experience!

### For information:

159 St. Antoine Street West, 4<sup>th</sup> floor, Montréal, Québec H2Z 2A7

Phone: 514 871-3111 – [info@capitaltraiteur.com](mailto:info@capitaltraiteur.com)

The Palais has been cultivating a rooftop vegetable garden since 2011. Simon Devost-Dulude, executive chef, enjoys picking his own fruit, vegetables and herbs for the dishes he prepares for Palais guests.



## A CREATIVE CATERER

### Discover our recipe for tasteful events

Our catering partner, Capital Catering, serves up an abundant choice of varied and imaginative menus for your business receptions and meals. Ask the Capital team to tailor your menu to match the theme of your event.

The members of this experienced and dedicated team will meticulously attend to every detail of your event. From the kitchen to the dining room, they will add the special touches to make your event unique. Regardless of the number of guests, from business meetings to closing dinners for international conventions, they will deliver outstanding service that will exceed your expectations.

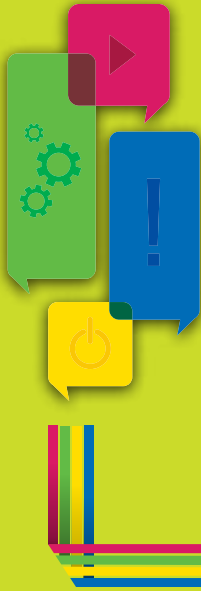

## LEADING THE WAY WITH A COMPREHENSIVE HIGH-TECH ENVIRONMENT

### Making technology work for events

The Palais is one of the leading technology-friendly convention centres in North America, offering the power of the latest technologies to event organizers, exhibitors and convention-goers. Meeting planners can also boost their event revenue by providing visibility opportunities to key sponsors.

### Wi-Fi network

Since quality communications are central to any event, we operate a robust and dependable infrastructure that delivers speeds that match your needs. More than 600 access points render the Palais a wall-to-wall wi-fi zone, which means we can support 20,000 simultaneous connections on a redundant 10 Gbps internet connection. All this, right in the centre of a district covered by the free MTLWiFi service for a totally integrated experience.

### Event intelligence infrastructure

Using state-of-the-art technology, the Palais offers organizers the chance to obtain a wide array of statistics on attendees based on the number of simultaneous connections and their internet consumption.

### E-commerce platform

Our e-commerce platform simplifies the lives of exhibitors by streamlining and accelerating the booking of Palais products and services. Important event information, deadlines and order forms are available online 24/7.

### Digital displays

The Palais houses an array of high definition screens that are picture perfect for advertising an event and generating revenue from sponsors. More than 90 FHD 55" screens (140 cm), including a 90 sq. ft. (8.5 m<sup>2</sup>) HD video visibility wall, provide a unique way to showcase and promote an event and an excellent opportunity to provide visibility to your key sponsors through media sponsorship.



**508,756 sq. ft. (47,265 m<sup>2</sup>) of rental space including:**

▪ 113 rooms and venues		
▪ Exhibition venues:	396,785 sq. ft.	(36,863 m <sup>2</sup> )
▪ Meeting rooms:	353,036 sq. ft.	(32,798 m <sup>2</sup> )
▪ Reception rooms:	499,498 sq. ft.	(46,405 m <sup>2</sup> )
▪ VIP rooms and Boardrooms:	5,294 sq. ft.	(492 m <sup>2</sup> )
▪ Ballrooms:	115,537 sq. ft.	(10,734 m <sup>2</sup> )
▪ Terraces:	28,172 sq. ft.	(2,617 m <sup>2</sup> )
▪ Offices:	12,865 sq. ft.	(1,195 m <sup>2</sup> )



## CONTACT US

**Main address**  
1001, Place Jean-Paul-Riopelle

**Administration**  
159 St. Antoine Street West, 9th floor  
Montréal, Québec H2Z 1H2  
CANADA

Phone: 514 871-8122  
1 800 268-8122  
info@congresmtl.com

[congresmtl.com/floorplan](http://congresmtl.com/floorplan)